

# BILTMOR DECK 5005

## Contents of the Biltmor box SKU # 5005

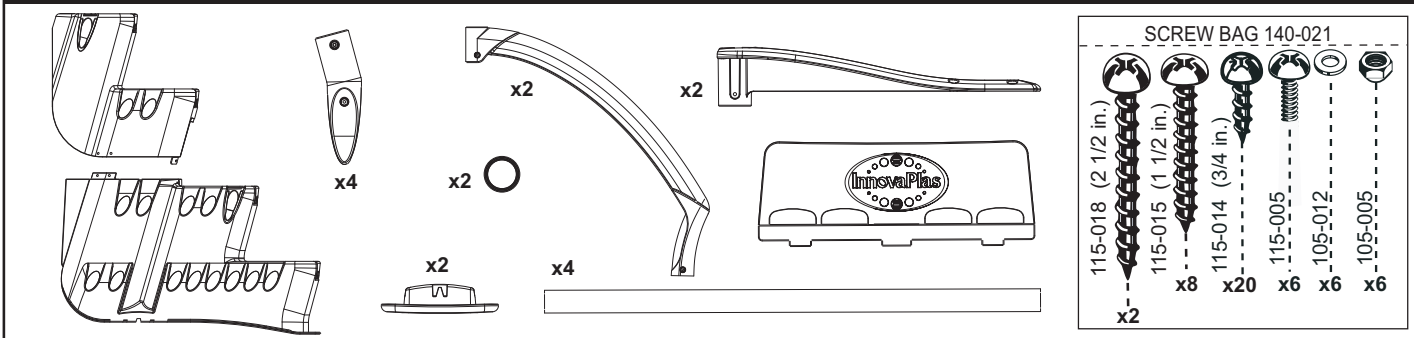

## ⚠ WARNING

- ◆ Do not dive or jump from step or ladder.
- ◆ Use BATTERY operated tools to avoid electric shocks.
- ◆ Install step on flat surface, following the manufacturers instructions.
- ◆ Remove step from pool during freezing climate season.
- ◆ Manufacturer cannot be held responsible for injuries caused by abusive use of product.
- ◆ Ask your city about specific regulations that apply to your above-ground pool and ladder.

## Tools required

(not included)

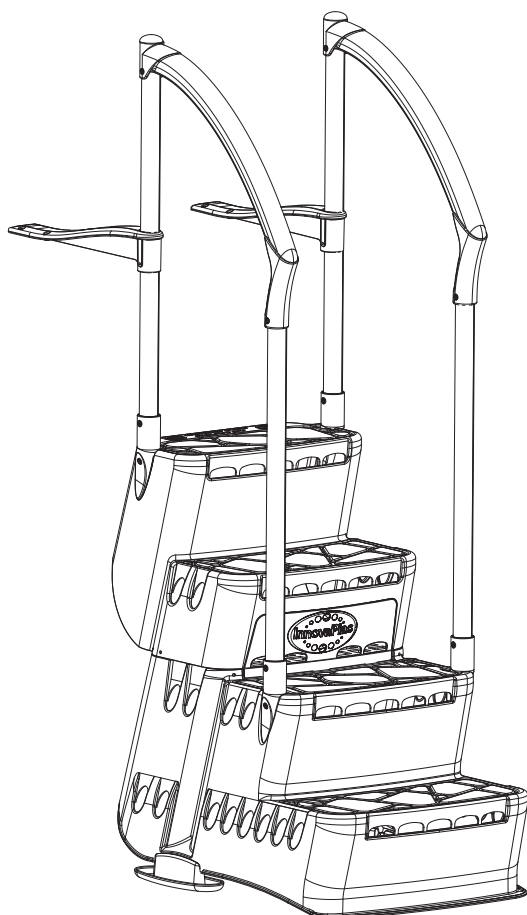
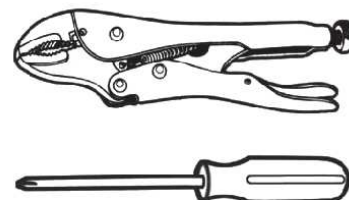

## A

- 1) Assemble the two main modules with the six screws, nuts and washers provided.
- 2) Snap the door between the top and bottom module within the slots provided.

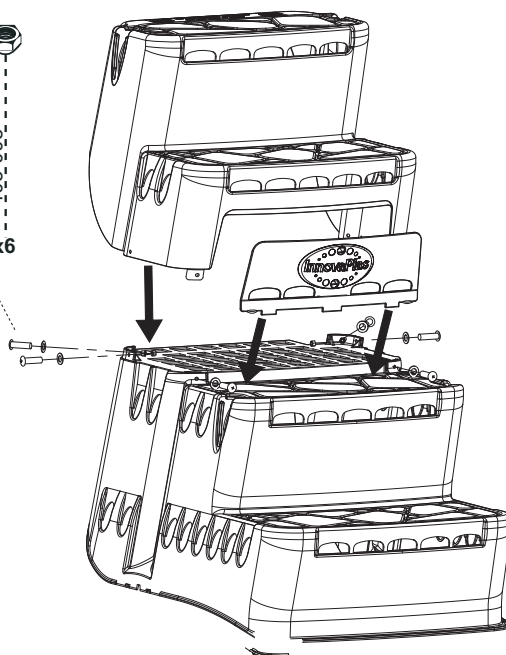
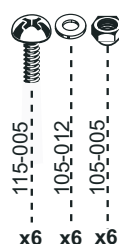

# B

1) Snap the four post ends into the step, making sure that the cylindrical part is vertical and that the ends are snapped properly in their respective housings.

2) Snap the 2 feet to the bottom of the step.

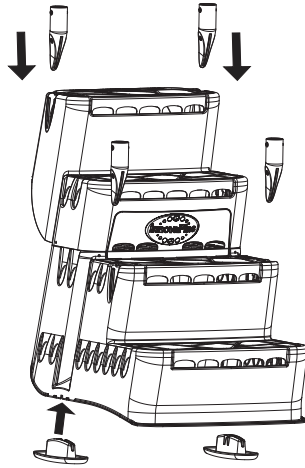

# C

1) Insert the four posts into the post ends and secure them in place with the screws provided.

2) Insert the two deck supports over the rear posts.

3) Insert the handrails on the four posts and secure in place.

4) Install the small post covers.

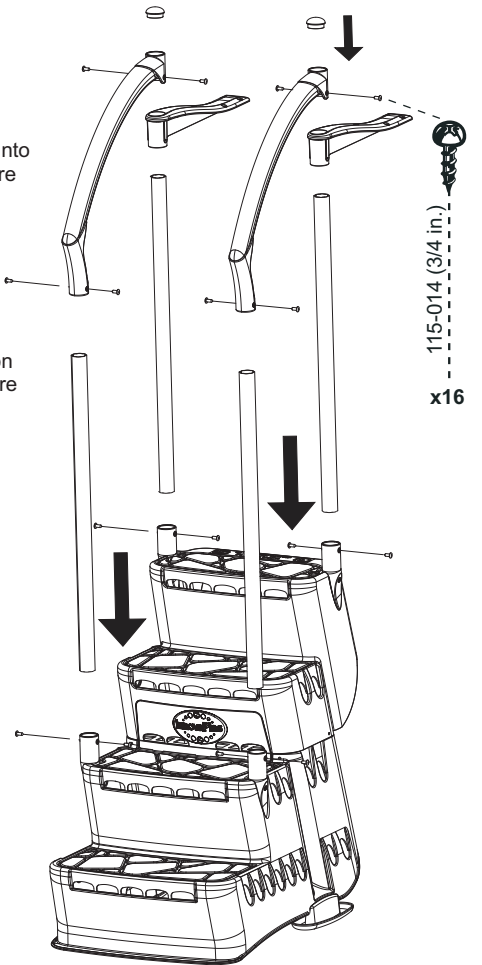

# D

1) Slowly submerge the step into the pool. Make sure you do not damage the pool liner in the process.

2) Angle the whole step so that it is entirely under water. This will purge all the air from under the steps.

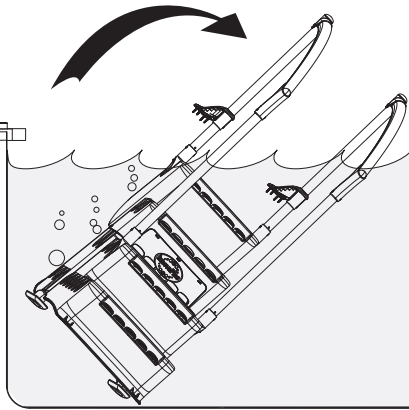

# F

1) Pull the deck supports (already fixed to the deck) upwards to create a spring effect on the step.

2) Fasten the supports to the two rear posts while pushing the entire step downwards.

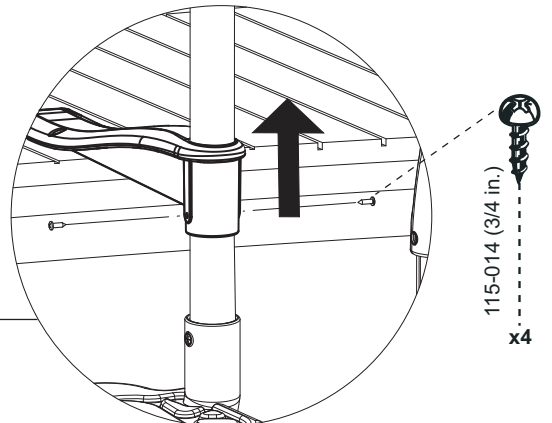

# E

1) Affix the deck supports with the screws supplied.

